

Symbol

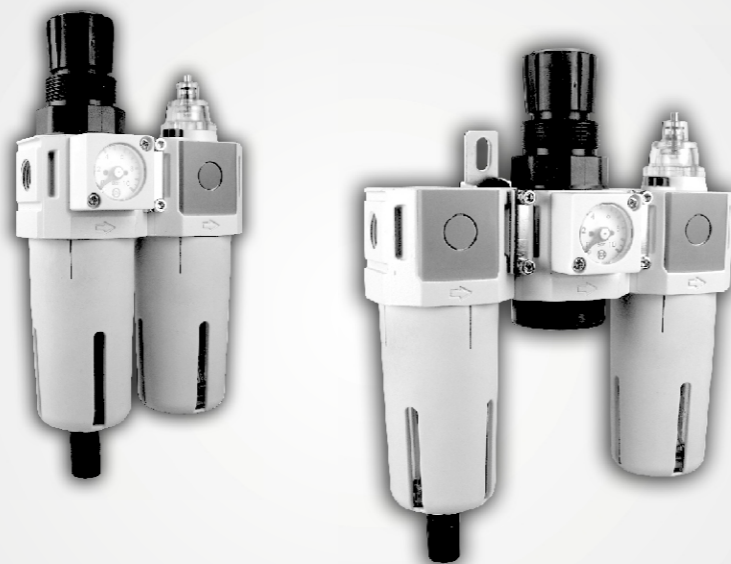
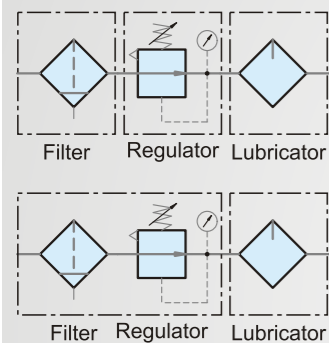

Features

- * Remove water and particle effectively.
- * Compact size with effective air service.
- * 40 μm and 5 μm filter element are easily interchangeable and replaceable.
- * Accurate and easy pressure setting.
- * Oil spray in mist ensures good lubrication for machines.

How to order

FRL700C		02	N	C	G	H
FRL700C	Miniature Filter+Regulator+Lubricator	Port size	Thread	Filtration	Gauge type	Drain
FRL600C	Miniature Filter Regulator+Lubricator	01 1/8" Option 02 1/4" Standard	Blank G N NPT	Blank 5 μm C 40 μm	Blank Square G Circle	Blank Semi-auto drain H Manual drain

Specifications

Model	FRL700C-01	FRL700C-02	FRL600C-01	FRL600C-02
Port size	1/8" (Option)	1/4" (Standard)	1/8" (Option)	1/4" (Standard)
Fluid	Compressed air			
Regulator construction	Diaphragm			
Body material	Aluminum die-cast			
Bowl material	Polycarbonate (Standard)			
Filtration	5 μm (Standard) / 40 μm (Option)			
Operating pressure range	0.5 ~ 9.9 kgf/cm ²			
Proof pressure (Standard bowl)	12 kgf/cm ²			
Max. flow rate l/min (ANR)	1875		1750	1850
Ambient temperature	-10 °C ~ 60 °C			
Lubricator oil (Recommended)	ISO-VG32			
Filter bowl capacity	40cc			
Lubricator bowl capacity	50cc			
Standard drain	Semi-auto drain (Drains below 0.5kgf/cm ²)			
Net weight	765g		560g	
Accessories	Pressure gauge, Mounting bracket, Plug, Screw x 2			
Option	Gauge plate			

Dimensions

FRL700C-01, 02

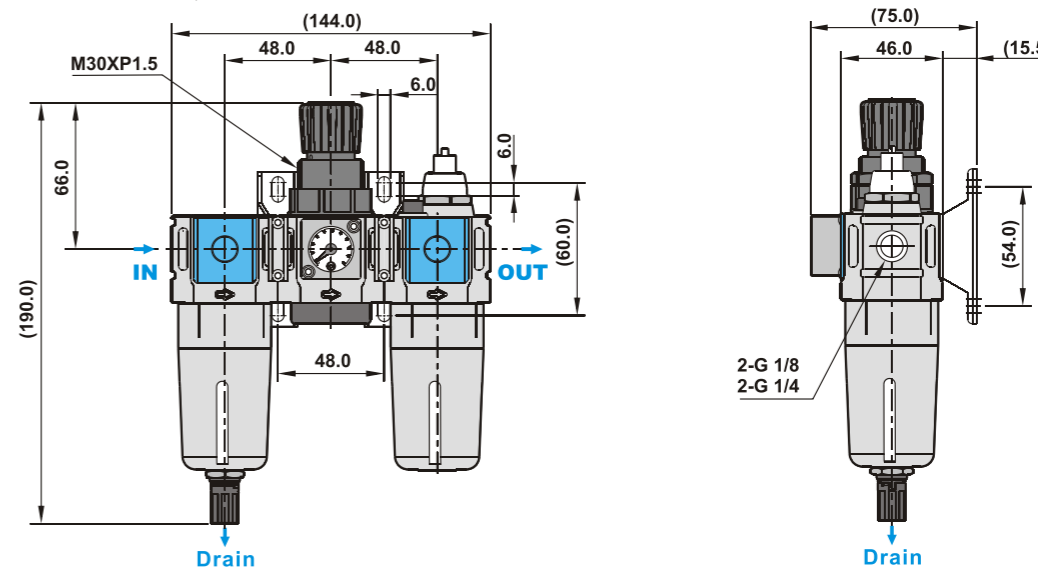

FRL600C-01, 02

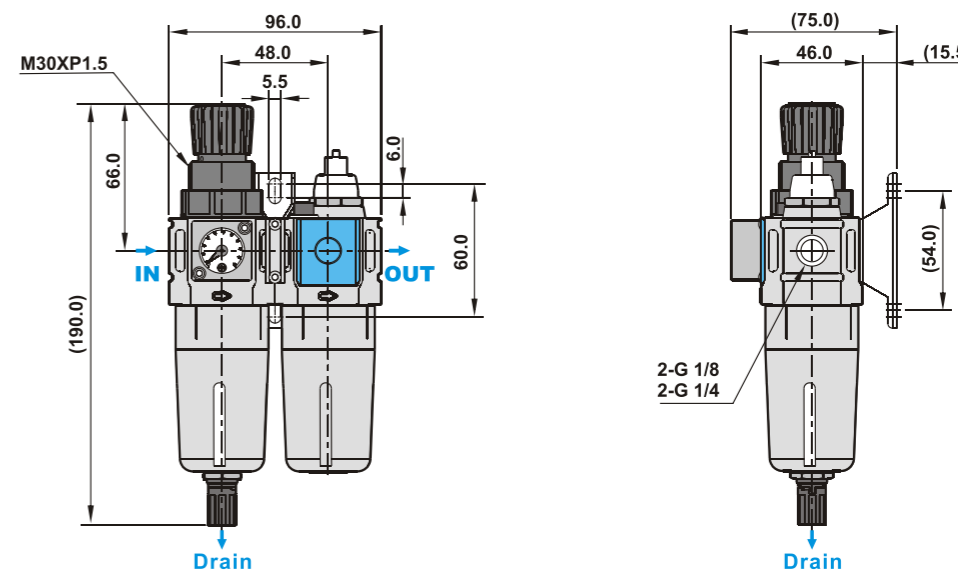

Flow chart

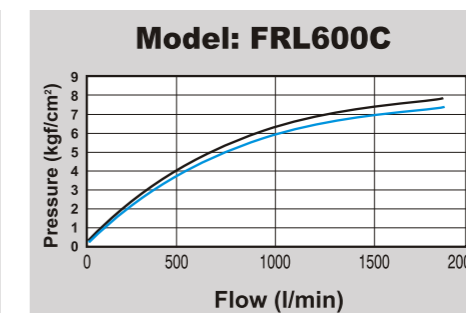
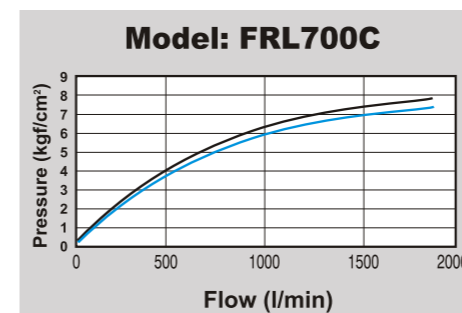

Note:
X axis: Flow (l/min)
Y axis: Pressure (kgf/cm²)
Blue line (P0) = Outlet pressure
Black line (P1) = Inlet pressure
P1-P0=Pressure range

Construction

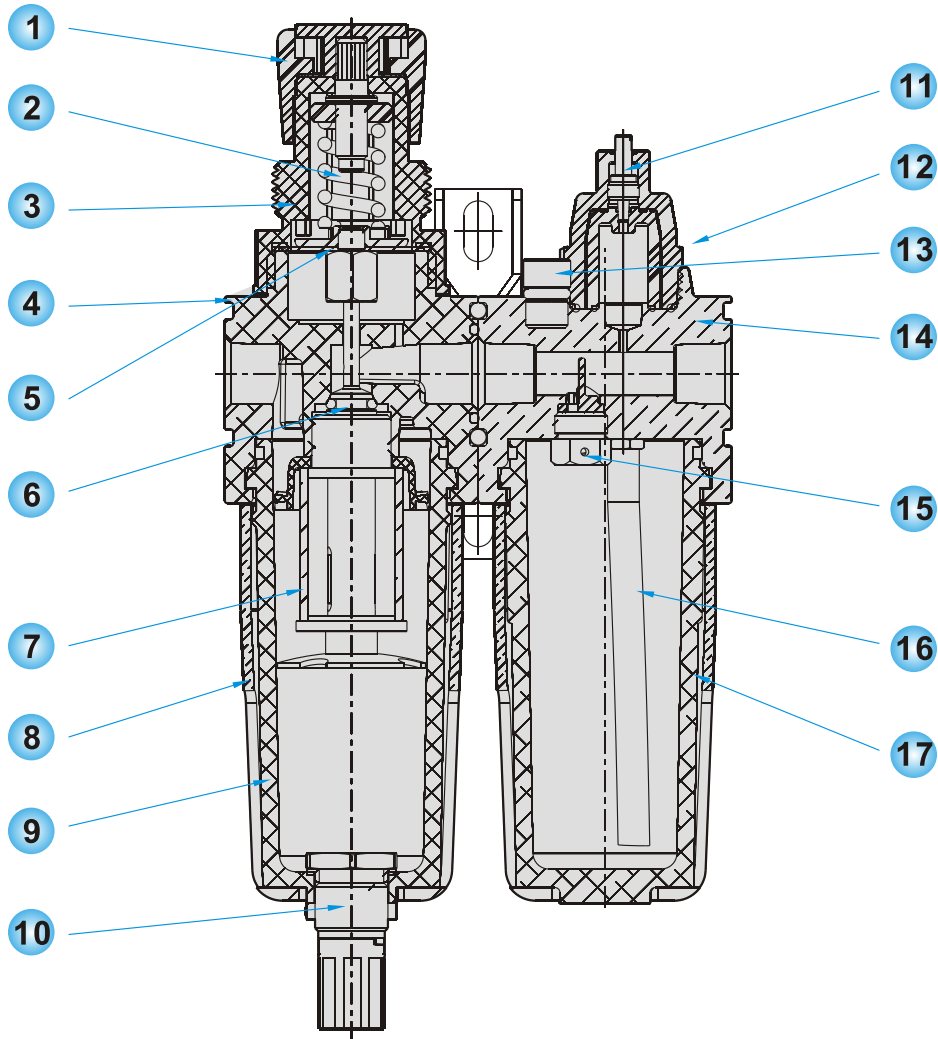

No.	Description	Material
1	Pressure regulating knob	NY
2	Spring	Spring steel+Ni
3	Regulator base	NY+GF
4	Regulator body	AL(ADC12)
5	Piston	AL(ADC12)
6	Pressure regulating needle	Cu+NBR
7	Filter element holder	Cu
8	Bowl guard	NY+GY
9	Filter bowl	PC

No.	Description	Material
10	Semi-auto drain	POM
11	Oil adjusting screw	Cu+Ni
12	Oil viewer	GV4H
13	Oil filling plug	Cu+Ni
14	Lubricator body	AL(ADC12)
15	Check valve	Cu
16	Oil pipe	PU
17	Lubricator bowl	PC